

## BRIDGE TIRE SWING ADAPTER

# Creative Playthings®

Adapter to mount the Tire Swing  
(63045-505) to the Connecting Bridge  
(SJ951-102).

If you have problems or questions, contact  
Creative Playthings Customer Service at  
1-800-598-4997 or  
[customerservice@creativeplaythings.com](mailto:customerservice@creativeplaythings.com)

Read the assembly instructions provided  
with your play set for additional warnings  
and safety information.

## Parts

### 50571-100 Bridge Tire Swing Adapter

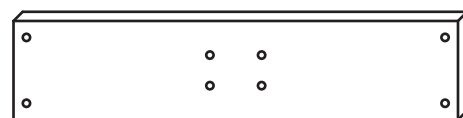

1 35487-102 Adapter 2 x 6 x 23-5/8"

### 50571-700 Hardware

4	17001-105	5/16" Weld Nut
8	12002-206	5/16" Flat Washer
4	12017-206	5/16" Lock Washer
4	17003-611	5/16 x 1-1/2" Hex Bolt
4	17036-1602	5/16 x 4" Lag Screw

5/16" Flat Washer

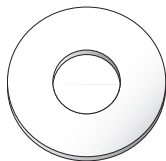

5/16" Lock Washer



5/16" Weld Nut

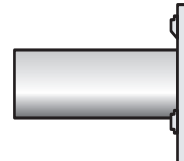

5/16 x 1-1/2" Hex Bolt

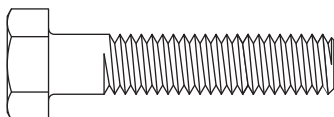

5/16 x 4" Lag Screw

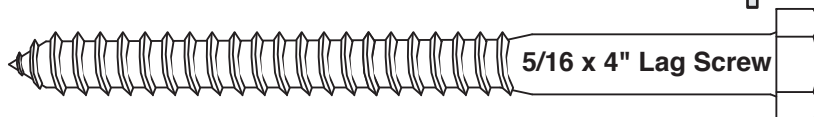

Make sure the area around the tire swing will be free of obstructions. Remove any protruding accessories which children using the tire swing might encounter, such as window boxes. Be sure use safety rails or other barriers to limit traffic below the bridge.

### STEP 01 – Bolt Tire Swivel to Adapter:

Push Weld Nuts into the four central holes in the Adapter.

Secure the base of the Swivel to the Adapter using four 5/16 x 1-1/2" Hex Bolts, Lock Washers, and Flat Washers as shown at right.

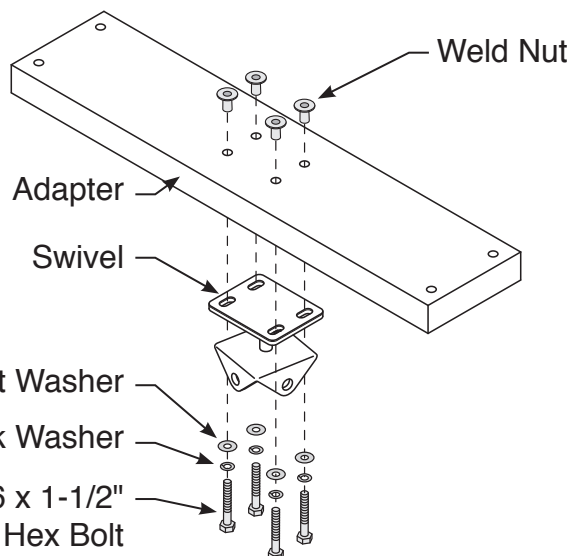

## ASSEMBLY INSTRUCTIONS

### STEP 02 — Secure Assembly to the Bridge:

Find the center of the Bridge. Align the center of the Adapter assembly to the bottom of the center of the Bridge as shown. Mark the position of the four holes in the Adapter onto the bottom of the front and back bridge supports.

Drill  $\frac{3}{16}$ " diameter holes  $2\frac{3}{4}$ " deep into the bridge supports at the marks. Secure the Adapter assembly to the bottom of the Bridge using four  $\frac{5}{16}$  x 4" Lag Screws with Flat Washers.

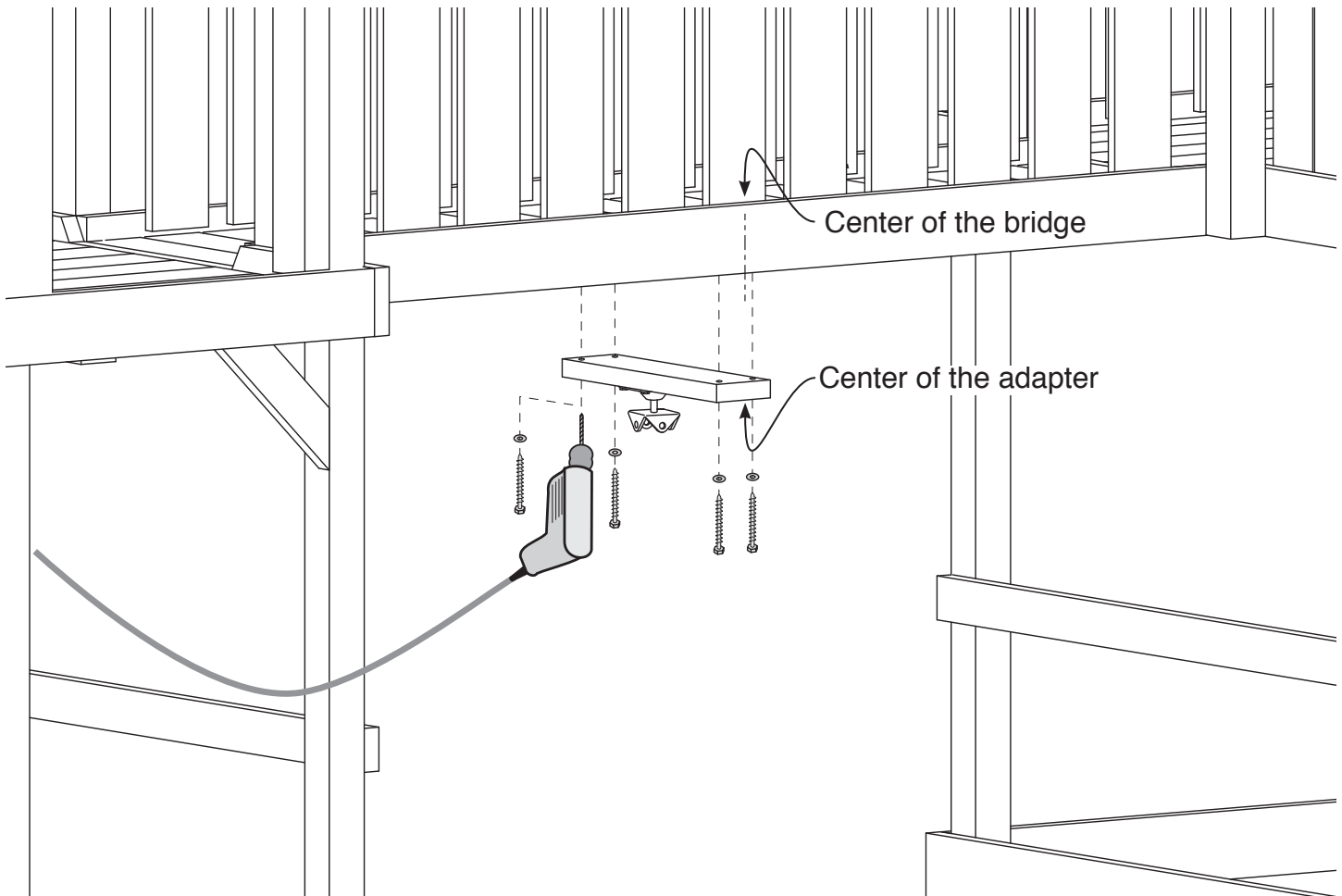

### STEP 03 — Hang the Tire Swing:

Find the instructions included with the tire swing. Assemble the Tire Swing as instructed. Fasten the tire swing to the Swivel as shown in the instructions.

